

26 LEITCH AVE  
TORONTO

PIN 102450415



This report was prepared by:

**ALI SALARIAN**

Broker

Cell:

salariandeals@gmail.com

**Pay Per Service Realty Inc**

7663 Yonge St #256

Thornhill, ON, Canada, L3T 0C6

Office: 905-209-7400



## Property Details

**GeoWarehouse Address:**

26 LEITCH AVE  
TORONTO  
M3J3P2

**PIN:** 102450415

**Land Registry Office:** METROPOLITAN TORONTO (80)

**Land Registry Status:** Active

**Registration Type:** Certified (Land Titles)

**Ownership Type:** Freehold



## Lot Size

**Area:** 2002.09 sq.ft

**Perimeter:** 239.5 ft

**Measurements:** 100.18ft x 20.04ft x 100.18ft x 20.03ft

**Lot Measurement Accuracy : HIGH**

Measurements are based on coordinate geometry, providing a high degree of confidence that the measurement calculations are within an acceptable variance of the registered plan dimensions.

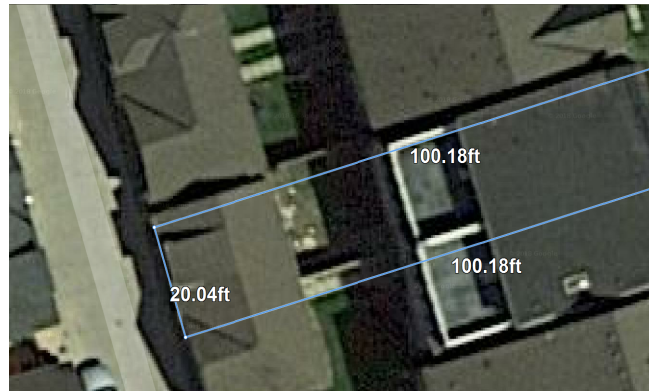

## Assessment Information

ARN

190803334004232

Phased-In Value	Assessed Value
\$666,750 2019 Tax Year	\$701,000 Based on Jan 1, 2016

Frontage: 20.01 ft

Depth: 100.07 ft

Description: Semi-detached residential

Property Code: 311

## Sales History

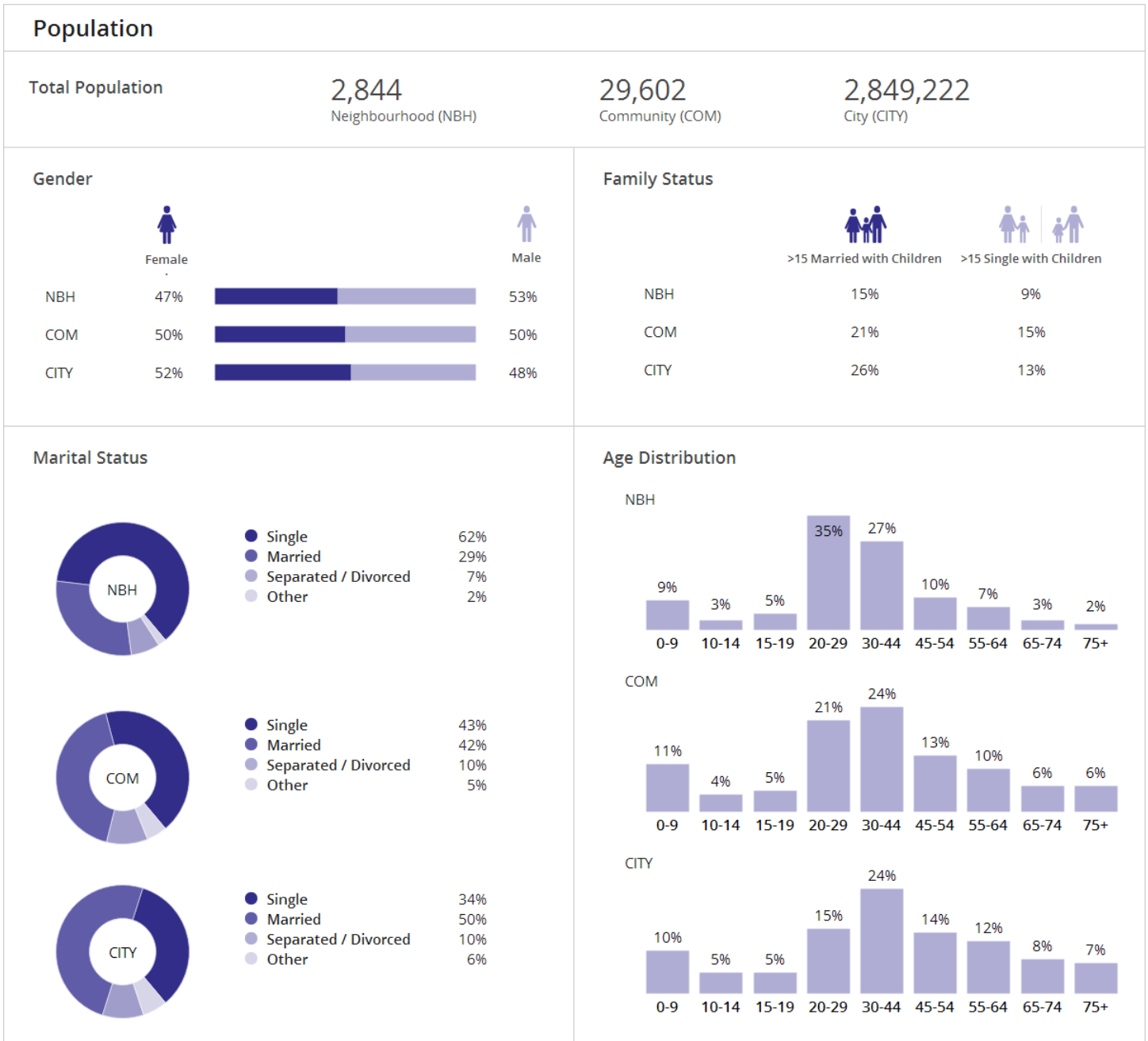

Sale Date	Sale Amount	Type	Notes
Dec 30, 2013	\$630,000	Transfer	
Aug 30, 2011	\$615,000	Transfer	
Jul 15, 2005	\$373,630	Transfer	

## Demographics



## Households

### Structure Details

	 Total # of Occupied Private Dwellings	 Dominant Year Built
NBH	1065	After 2011
COM	11418	1961-1980
CITY	1163126	Before 1960

### Ownership

	 Owned	 Rented
NBH	35%	65%
COM	46%	54%
CITY	54%	46%

### Age of Home (Years)

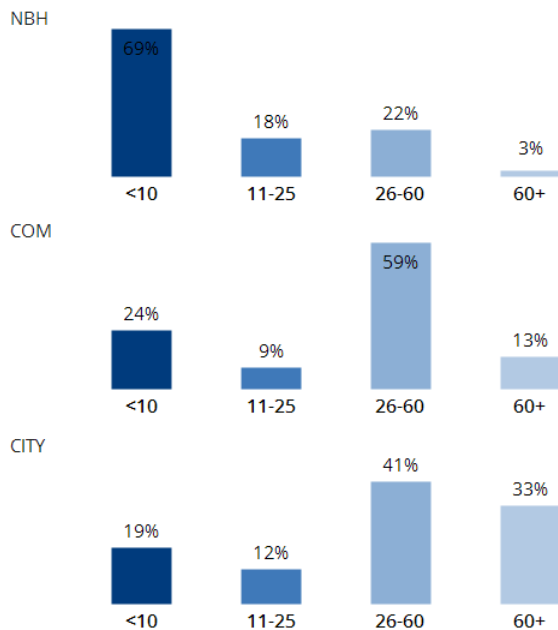

### Structural Type

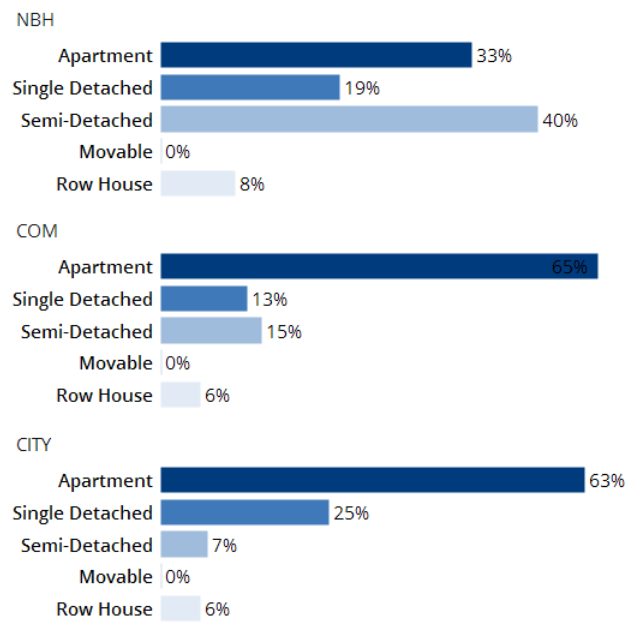

### Socio-Economic

Avg. Household Income

26565  
Neighbourhood (NBH)

54370  
Community (COM)

103381  
City (CITY)

#### Employment

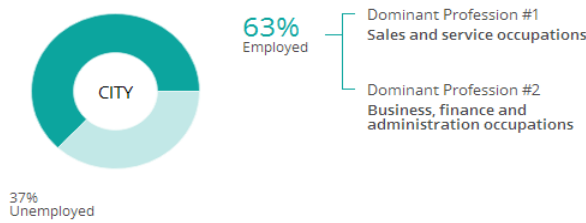
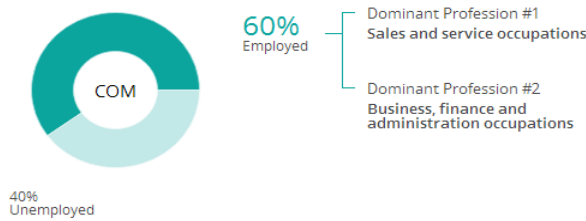
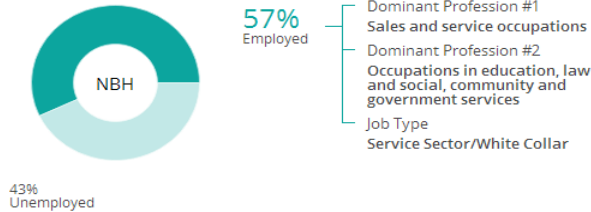

#### Highest Level of Education

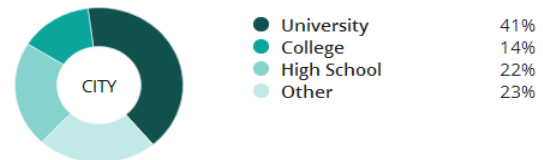
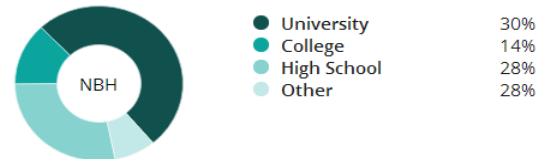
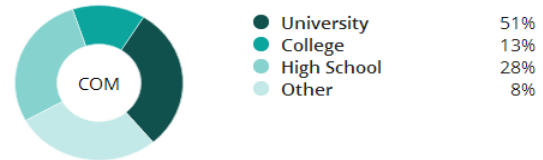

### Cultural

#### Dominant Language

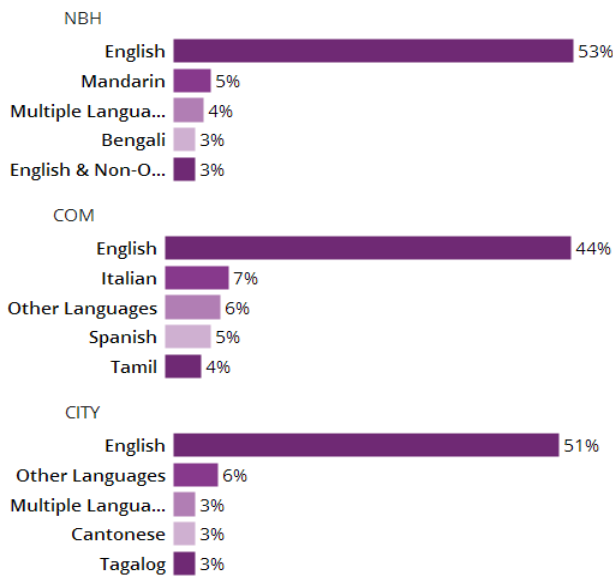

#### Immigration Status

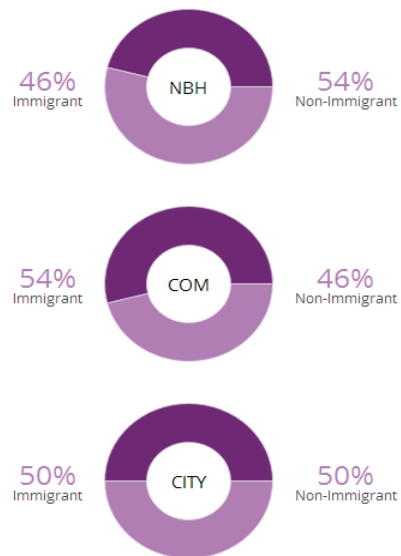

## Comparable Sales

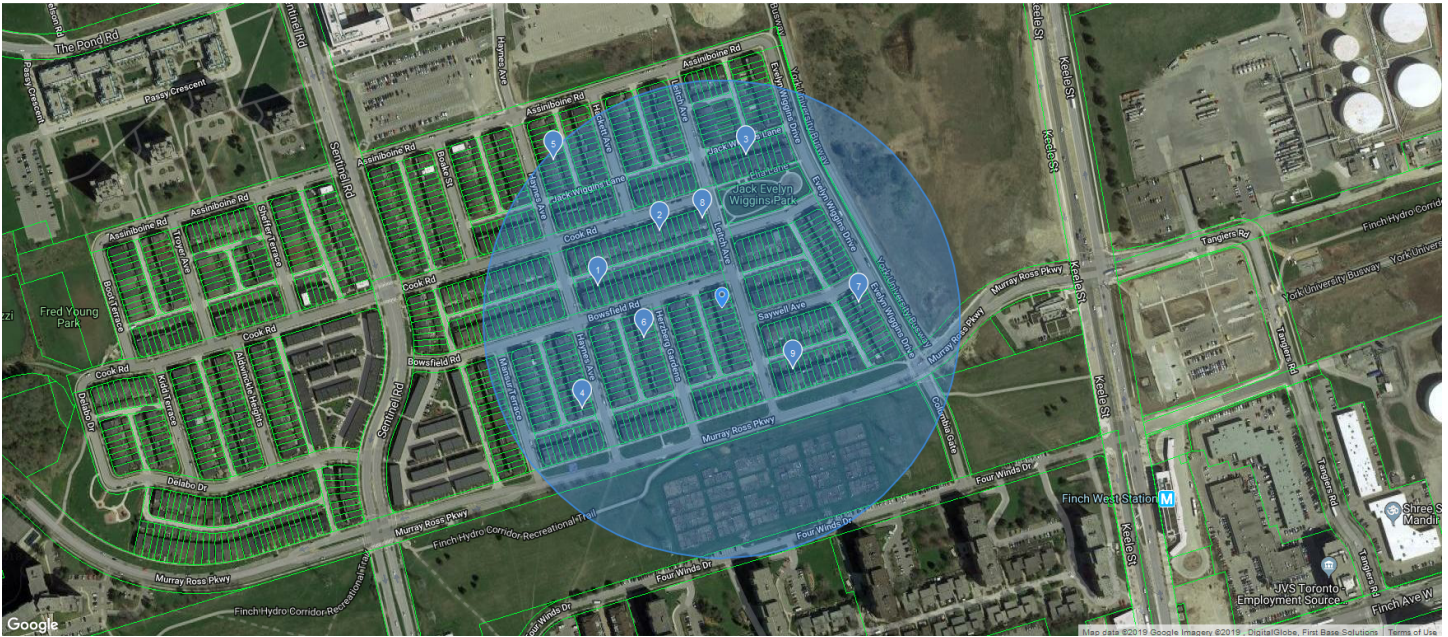

### Comparable Sales Search Results

#	Address	Date	Sales Amount (\$)	Lot Size (sq.ft)	\$/sq.ft	Distance (m)	PIN
1	40 BOWSFIELD RD, TORONTO, M3J3R3	Jul 31, 2018	820,000	2,002.00	410	133	102450481
2	263 COOK RD, TORONTO, M3J3T1	Aug 07, 2018	875,000	2,432.00	360	108	102450233
3	13 ELIA LANE, TORONTO, M3J0E5	Nov 13, 2018	820,000	2,098.00	391	168	102450889
4	10 HAYNES AVE, TORONTO, M3J3P6	Sep 17, 2018	1,030,000	2,895.00	356	177	102450296
5	63 HAYNES AVE, TORONTO, M3J0C3	Nov 20, 2018	820,000	2,002.00	410	238	102450798
6	26 HERZBERG GDNS, TORONTO, M3J3P4	Jul 31, 2018	825,000	2,002.00	412	85	102450518
7	20 JACK EVELYN WIGGINS DR, TORONTO, M3J0G3	Nov 30, 2018	860,000	2,098.00	410	144	102450940
8	48 LEITCH AVE, TORONTO, M3J3P3	Oct 02, 2018	1,060,000	3,207.00	331	102	102450238
9	251 MURRAY ROSS PKY, TORONTO, M3J0G4	Dec 03, 2018	810,000	2,260.00	358	94	102450960

### Sales Statistics

<b>Maximum:</b>	\$1,060,000
<b>Minimum:</b>	\$810,000
<b>Average:</b>	\$880,000
<b>Median:</b>	\$825,000

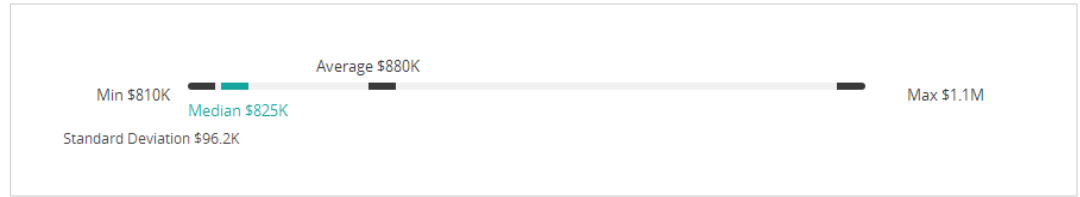

\*Standard Deviation: The smaller the number, the more similar are the sales results in the area. The larger the number, the more widely spread the sales results are in the area.

### Area Heat Maps

#### Average Sales Heat Maps - Last 1 Year

##### Block

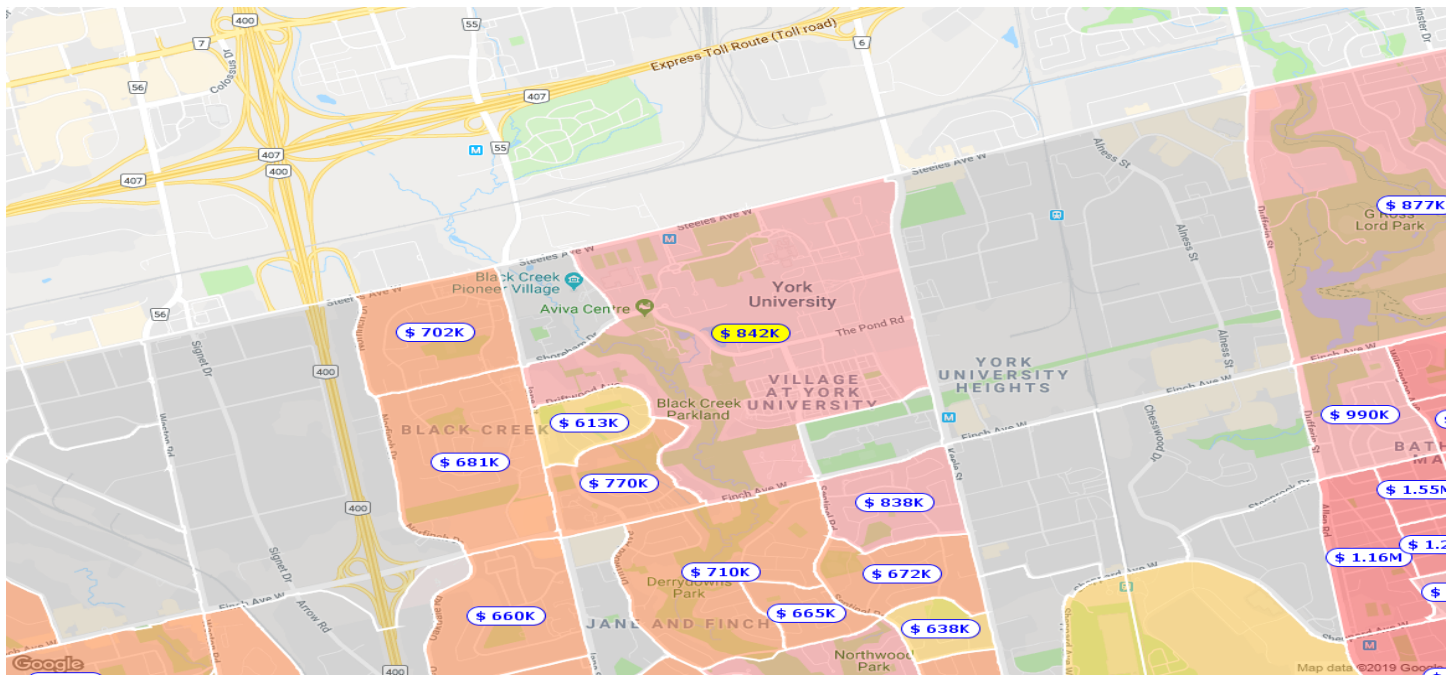



## Growth Rate Heat Maps - Last 5 Years

### Block

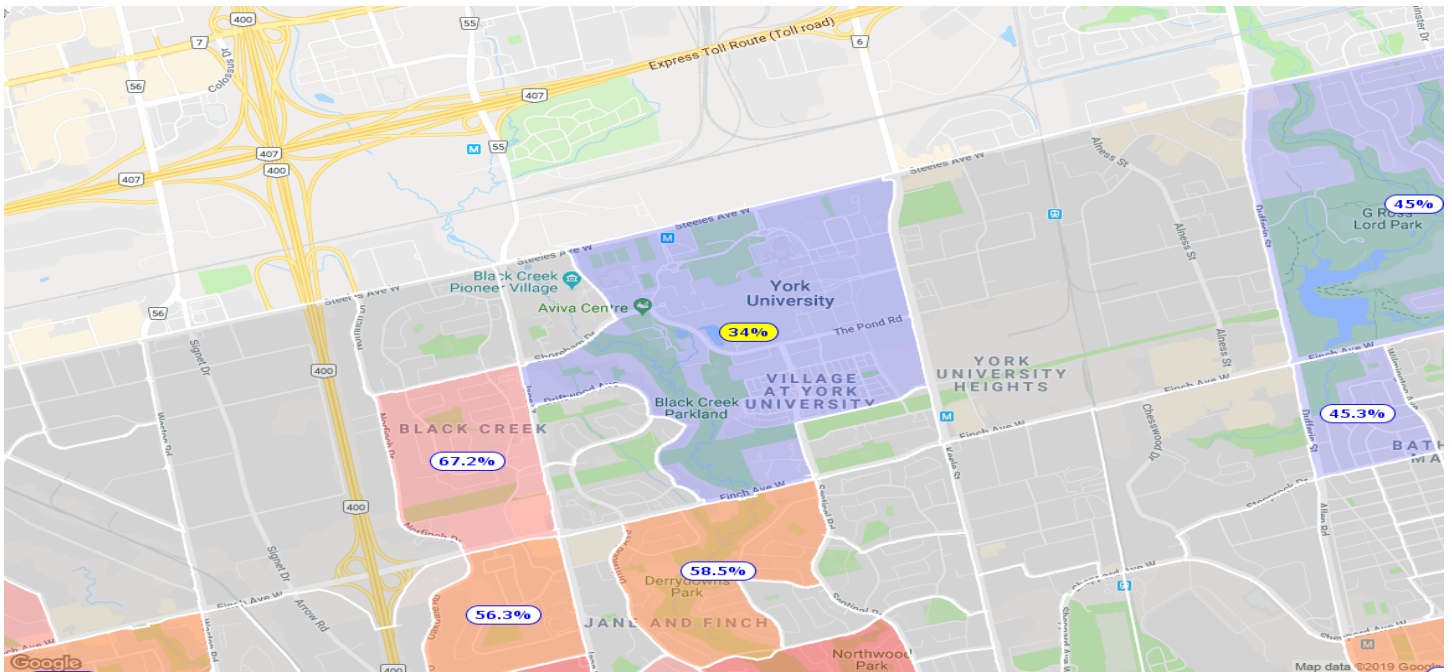

## Market Turnover Heat Maps - Last 1 Year

### Block



## Historical Market Trends

### Average Sale Values and Growth Rates

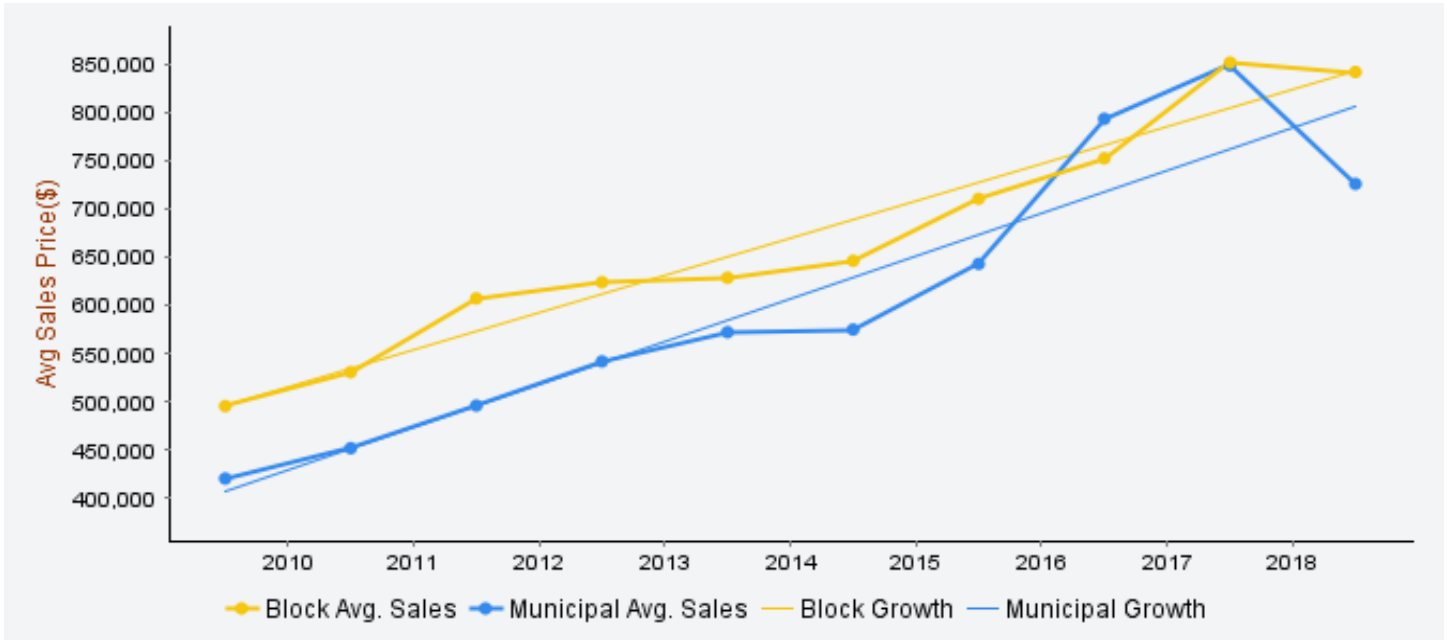

### Market Turnover Rates

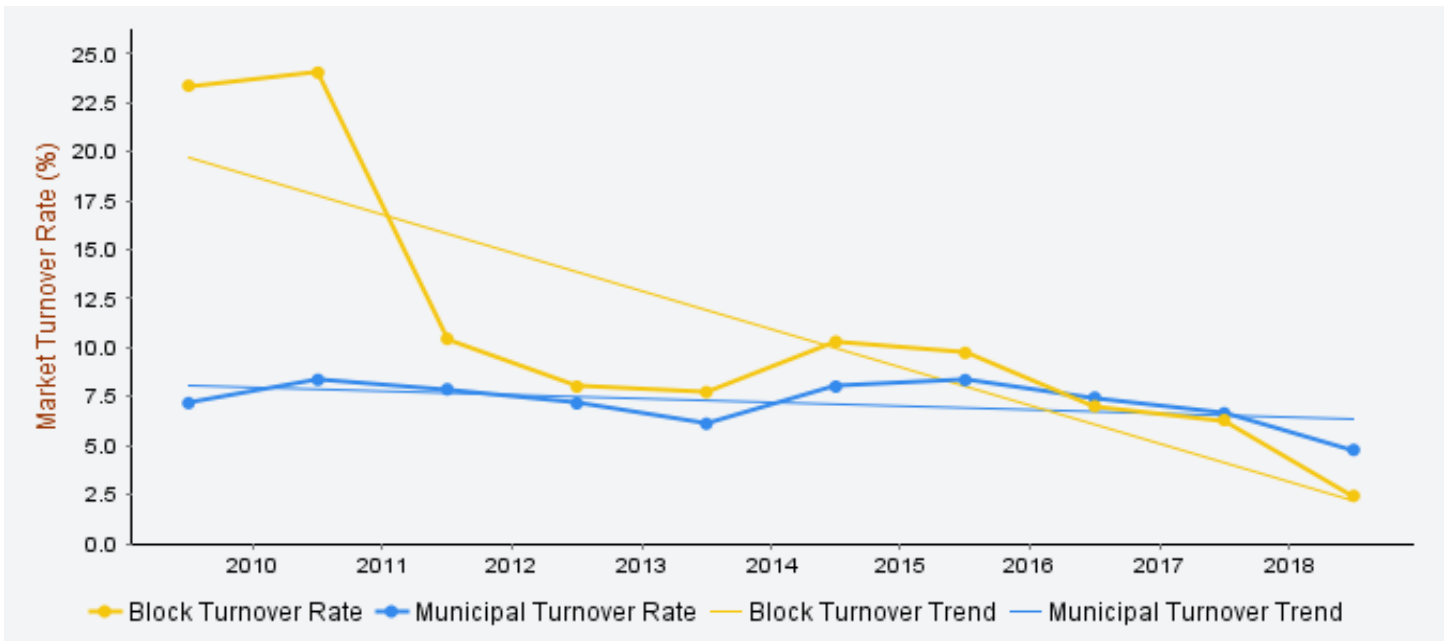

## Market Statistics

### Area Map



**5 Year Analysis**

Trending - Better move fast! Sales values for the neighbourhood are 3.2% higher than the municipal average, have grown at rates 26.3% higher than the average municipal growth, and properties change hands 4.4% more often than the rest of the municipality.

Average Sales Price - Last 1 Year	
<b>\$842,471</b>	<b>\$726,372</b>
Block	Municipality

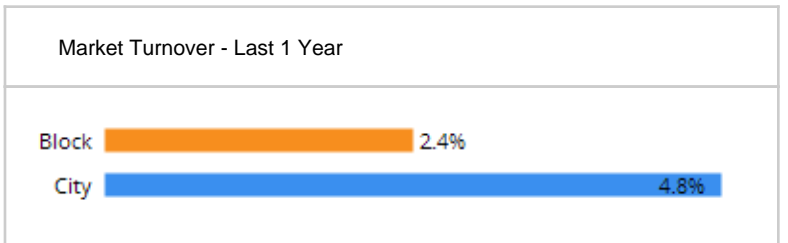
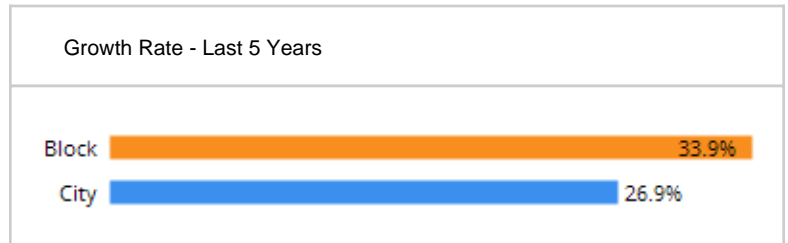

## Terms and Conditions

**Reports Not the Official Record.** Reports, other than the Parcel Register, obtained through Geowarehouse are not the official government record and will not necessarily reflect the current status of interests in land.

**Currency of Information.** Data contained in the Geowarehouse reports are not maintained real-time. Data contained in reports, other than the Parcel Register, may be out of date ten business days or more from data contained in POLARIS.

**Coverage.** Data, information and other products and services accessed through the Land Registry Information Services are limited to land registry offices in the areas identified on the coverage map.

**Completeness of the Sales History Report.** Some Sales History Reports may be incomplete due to the amount of data collected during POLARIS title automation. Subject properties may also show nominal consideration or sales price (e.g. \$2) in cases such as transfers between spouses or in tax exempt transfers.

**Demographic Information.** Demographic Information is obtained from Environics Analytics. Environics Analytics acquires and distributes Statistics Canada files in accordance with the Government of Canada's Open Data Policy. No information on any individual or household was made available to Environics Analytics by Statistics Canada. PRIZM and selected PRIZMC2 nicknames are registered trademarks of The Nielsen Company (U.S.) and are used with permission.

---

The Property Information Services, reports and information are provided "as is" and your use is subject to the applicable Legal Terms and Conditions. Some information obtained from the Land Registry Information Services is not the official government record and will not reflect the current status of interests in land. Use of personal information contained herein shall relate directly to the purpose for which the data appears in land registry records and is subject to all applicable privacy legislation in respect of personal information. Such information shall not be used for marketing to a named individual.

Parcel Mapping shown on the site was compiled using plans and documents recorded in the Land Registry System and has been prepared for property indexing purposes only. It is not a Plan of Survey. For actual dimensions of property boundaries, see recorded plans and documents.